



## CAUTION

Use all applicable Safety precautions while working on, around or under any machinery.

Estimated time to install kit is 2 hours, plus 32 hours cure time for the urethane sealer and the adhesive hook material.

### Machine Preparation

1. Keep the machine in an area where the temperature will be at least 70° F (20° C). Let the machine stand until the machine surface has attained this temperature.
1. Park the machine on a firm, level surface. Level the machine to the ground, fully retract the boom, raise the boom to approximately 40°, place the travel select lever in the (N) NEUTRAL position and engage the parking brake.



## WARNING

DO NOT get under a raised boom unless the boom is blocked up. Always block the boom before doing any servicing which requires the boom to be raised.

2. With the steering mode in four wheel steer, turn the wheels all the way to the right. Shut the engine OFF.
3. Place a Do Not Operate Tag on both the ignition key switch and steering wheel stating that the machine should not be operated.
4. Disconnect the battery negative (-) cable from the battery negative (-) terminal.
5. Clean the surface of the cab openings (1) with a glass cleaner. DO NOT use ammonia based glass cleaner.

**Note:** If skylight grill (2) is excessively dirty, clean now. Clean will be more difficult once installation is complete.

ALL DRAWINGS ARE FOR REFERENCE ONLY

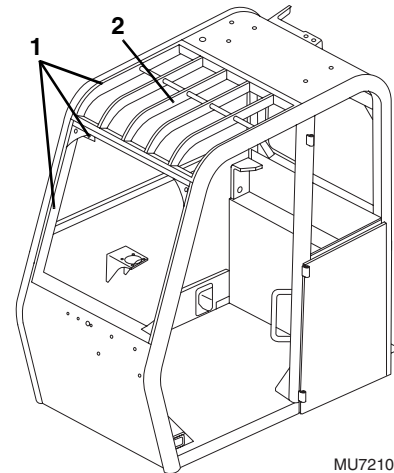

MU7210

### Windshield/Skylight Preparation

1. Lay out the parts with the black border facing up. Place the glass on a protective surface such as the bubble wrap packaging or cardboard.
2. Using glass cleaner, clean the skylight glass and windshield.

### Windshield Installation

1. Attach two of the adhesive backed setting blocks (3) to the bottom edge of the cab opening. These blocks will protect the bottom edge of the glass.
2. Apply a 3/8" to 1/2" (9 to 13mm) diameter bead of urethane sealer (4) around the opening.

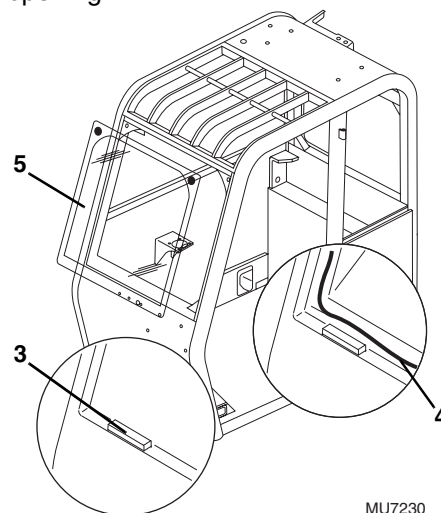

MU7230

B  
02/08

3128478



- Place the windshield glass (5) in cab opening. Make sure it is centered on the opening and does not contact any cab metal. Space between the glass and the cab metal is required for possible expansion and contraction. Press the glass firmly in place to ensure proper bonding of the glass and sealer. Duct tape corners of the windshield to cab until urethane sealer has cured.

### Skylight Installation

- Attach four of the setting blocks (6) around the top opening of the cab. Place the setting blocks so they will be completely under the glass and parallel with the edge of the opening.

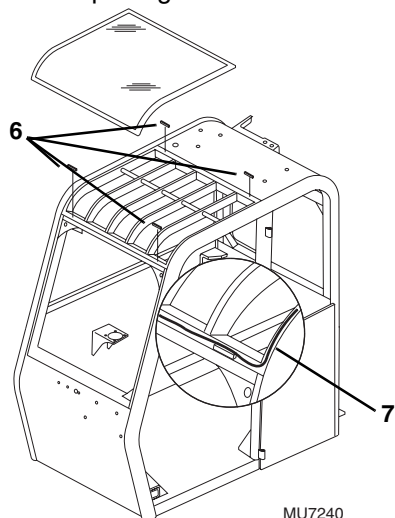

- Apply a 3/8" to 1/2" (9 to 13mm) diameter bead of urethane sealer (7) around the opening and over the top of the setting blocks.
- Place the skylight glass in the top of the cab opening, front edge first. Make sure it is centered on the opening and does not contact the cab metal. Space between the glass and cab metal is required for possible expansion and contraction. Press the glass firmly in place to ensure proper bonding of the glass and sealer. Duct tape corners of the skylight to cab until urethane sealer has cured.
- Refrain from using the machine while urethane sealer is curing. Normal cure time for urethane is 24 hours at 70° F (20° C) and 50% humidity. Lower temperatures and/or lower humidity will lengthen the cure time.

### Vinyl Panel Installation

**Note:** Masking tape can be applied before velcro is attached to provide an on-cab template.

- Use soap and water, or an alcohol-based cleaner, to clean cab door entry surfaces where velcro strips will be applied. Allow surfaces to dry completely. DO NOT use an ammonia-based glass cleaner.
- Apply velcro strips (8). Cut slits or notches in velcro strips to accommodate installation around hinges (9) in the center pillar.

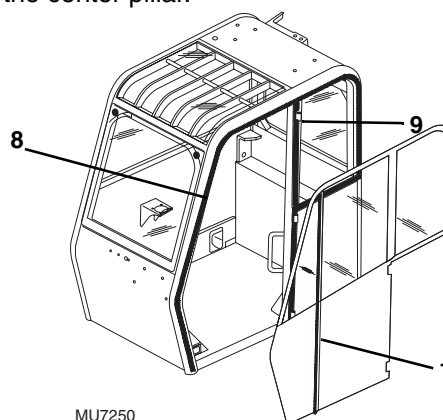

- Remove any masking tape and residue adhesive that may have been used to apply velcro strips.
- Connect outer vinyl sections, right side, rear and door entry, to the applied velcro strips.

### Enclosure Care and Maintenance

- When entering or leaving the cab, make sure the zipper (1) is open far enough to allow easy entry or egress. Constant tugging on the zipper, vinyl sections and velcro can cause damage to the enclosure over time.
- To prevent damage to vinyl windows, always use a soft, clean cotton cloth with warm water and mild soap for cleaning.
- Rinse the entire enclosure to loosen and remove surface dirt, before cleaning windows.

**IMPORTANT:** Clear vinyl windows can be scratched as even small dirt particles are being wiped away. Use very gentle sudsing motions.

- Never use standard window cleaners or solvents, bleach or ammonia-based cleaners to clean any part of the enclosure.



## CAUTION

DO NOT transport the machine with the enclosure attached. Wind gusts and repeated tugging could damage the enclosure.